

TESA μ -HITE

THE COMPACT AND ACCURATE MEASURING STATION
TO USE DIRECTLY ON THE PRODUCTION LINE

DUBUIS, Blois Cedex, France



The measuring station TESA μ -HITE accelerates the control process of components manufactured by Dubuis for the electrical, railway, health and aeronautic industries.



The Dubuis company capitalizes great knowledge in the design and manufacture of a wide range of portable products.

The fast and reliable control of its components is one of the fundamental points for an ever increasing productivity and it avoids any waste of time and resources.



Measuring the sleeve of a crimping tool using the TESA-μHITE measuring station

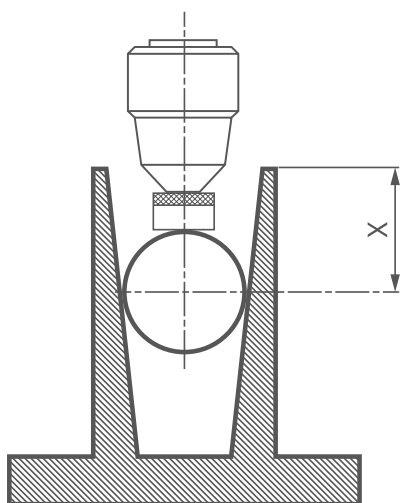

Determination of the internal cone angle of a sleeve by comparing the height difference between the upper surface of the part and the height measured on a reference ball.

Therefore Dubuis chose the TESA μ-HITE measuring station.

With an application range of 100 mm, suitable for laboratories as well as workshops, the TESA μ-HITE is particularly adapted for the measurement of small parts.

Thanks to 1 μm precision and its compact shape, it can easily be integrated into a production area to allow accurate measurements in the long term on many types of materials with a low and adjustable measuring force.

Established for more than 60 years in Blois in Centre-Val de Loire (France), in 2006 Dubuis has been part of the Stanley group and since 2010 part of the Stanley Black and Decker group and today employs 92 people in Research & Development, Manufacturing, Assembly, After-sales Service and Sales.

Dubuis sells its products throughout the world via distributors specialized in Building, Public Works and Railways as well as customers such as RATP (Autonomous Operator of Parisian Transports), EDF (Electricity of France), ALSTOM and BOMBARDIER.

For one of its products, Dubuis uses the μ-HITE to determine whether the internal cone angle of a sleeve meets the expected specifications. To do this, he compares the height difference between the upper surface of the part and the height of a reference ball measured by a flat probe.

“We have 2 TESA μ-HITE directly installed on turning machines that are used in three shifts. They measure about 100 pieces each day.” explains Laurent Hernandez, Industrial Development Manager.



The time for control operations is considerably reduced.



On the left: tool manufactured by Dubuis

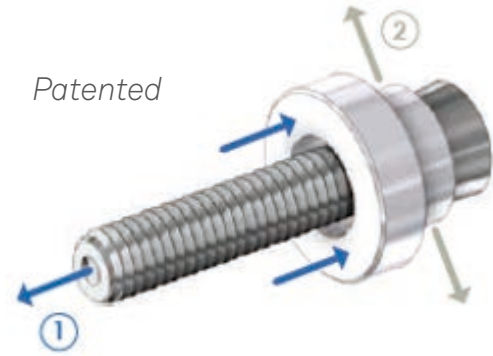

On the right: grinding insert

“Ten years ago, when we bought the first TESA μ -HITE, we chose this instrument because we were looking for a compact and easy to use solution for our workstation. This product suits perfectly for its compact footprint and integrated granite. In addition, the accuracy and repeatability are very good and the panel does not require any special training,” states Mr. Hernandez.

This system combination with the control panel is indeed a significant advantage in terms of productivity. The “learning” mode linked to the execution speed can have a positive impact on the output of a production line.

Therefore, the TESA μ -HITE presents itself as a solution that is easily accessible, but no less effective, and whose flexibility is the assurance of a product adapted to a vast field of applications and user profiles.

“The time for control operations is considerably reduced.” this is the conclusion drawn by the French company, “because the possibility of placing the instrument as close as possible to the production site allows us to save precious time and also to gain in precision” concludes Mr. Hernandez.

“ 10 years ago, when we bought the first TESA μ -HITE, we chose this instrument because we were looking for a compact and easy-to-use solution for our workstation.

We would like to thank the company DUBUIS for their friendly support and for the authorization to publish this case study.



HEXAGON

MANUFACTURING INTELLIGENCE

Hexagon Manufacturing Intelligence helps industrial manufacturers develop the disruptive technologies of today and the life-changing products of tomorrow. As a leading metrology and manufacturing solution specialist, our expertise in sensing, thinking and acting – the collection, analysis and active use of measurement data – gives our customers the confidence to increase production speed and accelerate productivity while enhancing product quality.

Through a network of local service centres, production facilities and commercial operations across five continents, we are shaping smart change in manufacturing to build a world where quality drives productivity. For more information, visit HexagonMI.com.

Hexagon Manufacturing Intelligence is part of Hexagon (Nasdaq Stockholm: HEXA B; hexagon.com), a leading global provider of information technologies that drive quality and productivity across geospatial and industrial enterprise applications.

[COORDINATE MEASURING MACHINES](#)
[3D LASER SCANNING](#)
[SENSORS](#)
[PORTABLE MEASURING ARMS](#)
[SERVICES](#)
[LASER TRACKERS & STATIONS](#)
[MULTISENSOR & OPTICAL SYSTEMS](#)
[WHITE LIGHT SCANNERS](#)
[METROLOGY SOFTWARE SOLUTIONS](#)
[CAD / CAM](#)
[STATISTICAL PROCESS CONTROL](#)
[AUTOMATED APPLICATIONS](#)
[MICROMETERS, CALIPERS, HEIGHT GAGES, ETC...](#)
[DESIGN AND COSTING SOFTWARE](#)



TESA

TECHNOLOGY

Established in 1941 and headquartered in Renens, Switzerland, TESA SA manufactures and markets precision measuring instruments that stand for quality, reliability and longevity.

For more than 75 years, TESA has distinguished itself in the market through its excellent products, its unique expertise in micromechanics and precision machining as well as its proven experience in dimensional metrology.

The TESA brand is the global market leader in the field of height gauges and a pioneer thanks to its wide range of instruments, including callipers, micrometers, dial gauges,

lever-type dial test indicators and inductive probes. TESA is a true benchmark for the inspection of incoming goods, as well as for production workshops and quality assurance laboratories.

Through its worldwide distribution network the company focuses on the mechanical engineering, micromechanical, automotive, aerospace, watchmaking and medical industries.

In 2001, TESA became part of Hexagon, a leading global provider of information technologies.

TESAtechnology.com